

CAN YOU SAFELY

SPAN A GAP ?



How can you design a structure that supports a plastic bottle over a 1-foot gap?



WHAT STRUCTURES CAN SUPPORT HEAVY THINGS?

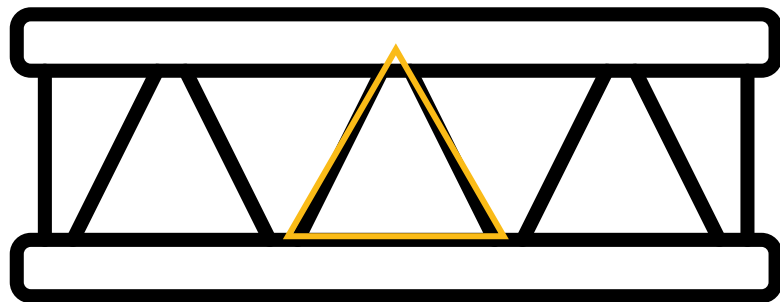

"**Trusses**" are triangular supports.

Towers and columns can be good supports!

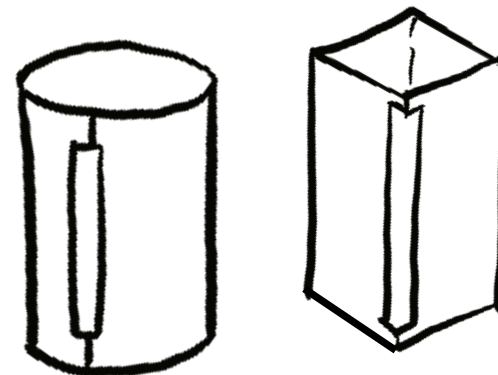

DESIGN THE DECK!

The deck of your structure is where the plastic bottle will be placed.

What material? What does it look like?
What supports it?

RULES:

1) The deck must be suspended or supported in some manner.

This means the deck cannot be a straight plank or a simple box.

2) Minimize the materials you use by pushing yourself to be creative.

How can you make a strong structure while minimizing what you use?

HERE ARE SOME EXAMPLES !!

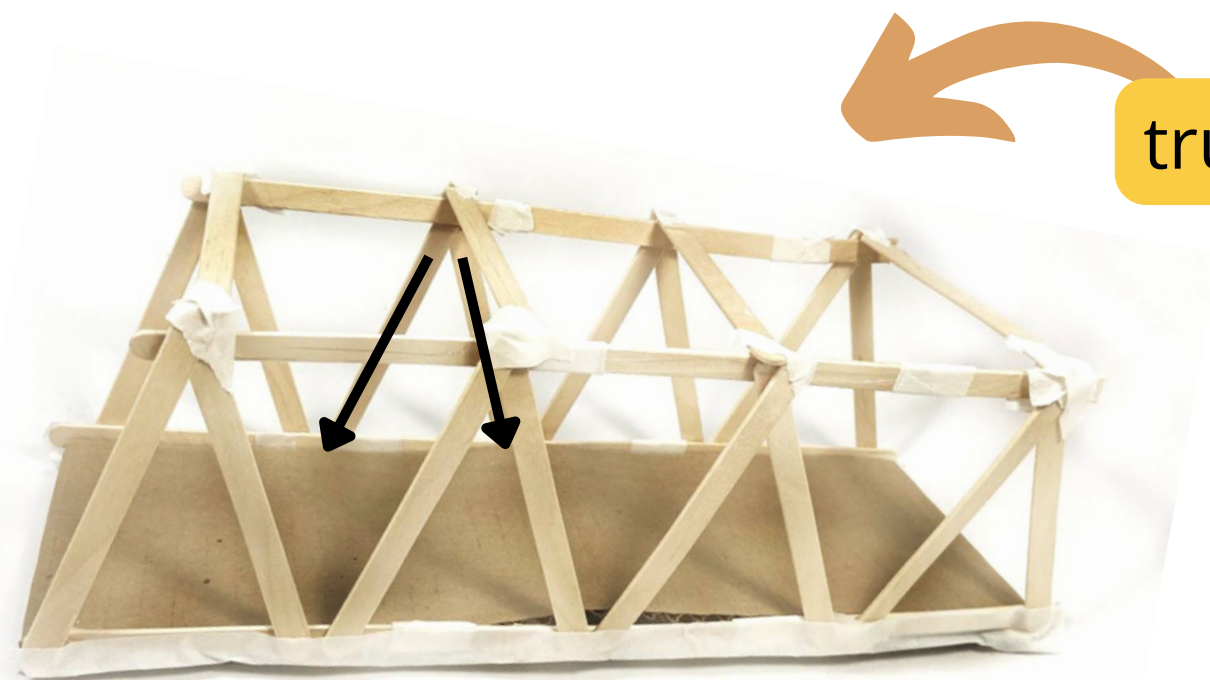

trusses



triangular prism legs

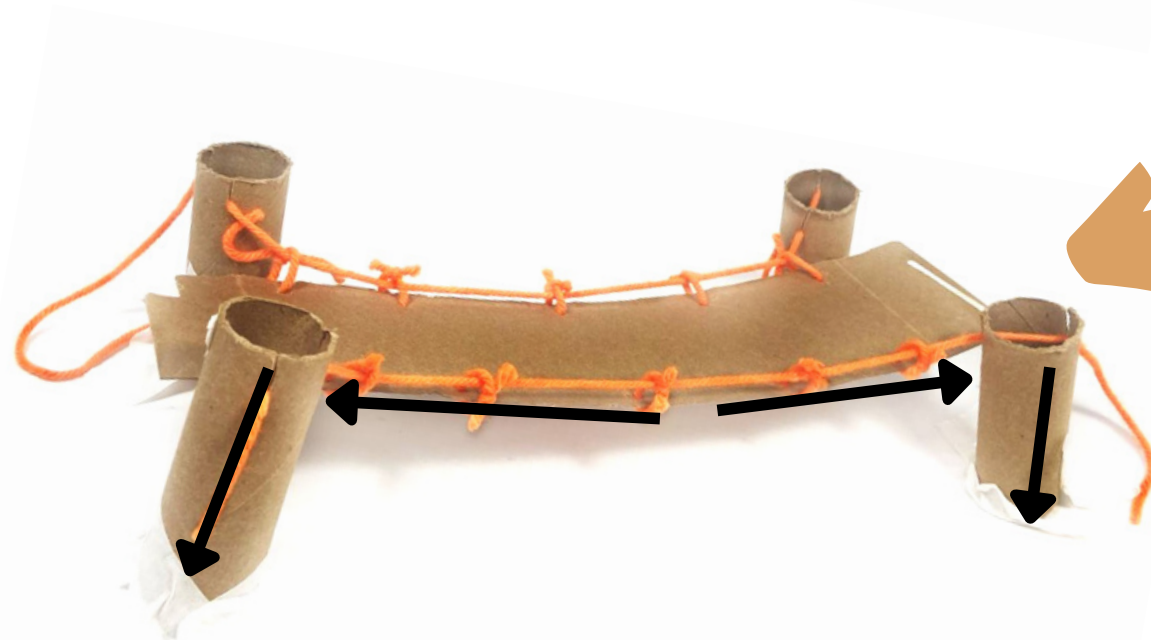

strings hold up the deck

