

# Futrall Hall



Futrall Student Room



**Street Address:**  
585 N. Lindell Street  
Fayetteville, AR 72701

**Mailing Address:**  
*Your Name*  
Futrall Hall (*Your Box #*)\*  
1106 W, Maple St.  
Fayetteville, AR 72701  
\* Mail for Futrall is delivered to  
the Garland Commons desk  
at the Northwest Quad

Garland Commons  
Front Desk: 479-718-7802

## Double Room Features

2 Twin loftable beds (Mattress:  
Window side: long twin (36" x 80")  
Door side: regular twin (36" x 75")  
2 Single desks (48" x 24" x 30")  
2 Hutch/Bookshelves (48" x 10" x 23")  
2 Desk chairs (23" x 21" x 33")  
2 Wardrobes (35" x 24" x 81")  
2 Chests of drawers (16" x 18" x 50")  
2 Bulletin boards under bookshelves  
Window with blinds (45" W x 51" H)  
Ledge (11'7" x 13" x 37")

Bedrooms are approximately 13'7" deep  
and 11'7" wide

This hall has other floor plans different from the  
one shown, please see the Futrall Hall web  
page for more information.

Room amenities include, but are not limited to:

- Ethernet access
- Cable TV
- Networked smoke detector

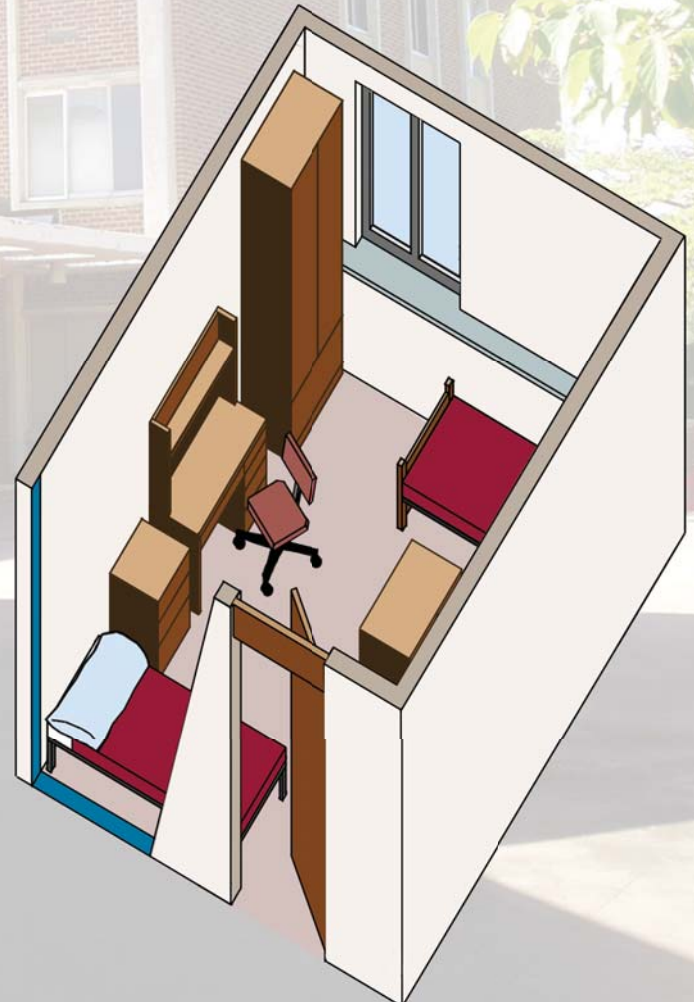

# Futtrall Hall

Futtrall Hall, with 190 students, is home to the Agriculture, Food and Life Sciences and Health Professions Living Learning Communities. Futtrall features recently refurbished first floor and ground floor lounges.

Futtrall Hall view from southeast



## FIX IT

<http://housing.uark.edu/fixit>  
479-575-7005

- Student room repairs
- Replace burnt-out lights
- Bathroom sanitation

## ResNet

<http://housing.uark.edu/ResNet>  
479-439-8070

- Assistance connecting devices
- Assistance with bandwidth issues
- Help with wireless connection



## Safety Features

### Security

- Exterior doors locked or supervised 24 hours a day
- Smoke/particle detectors
- Common-area sprinklers
- Closed circuit TV coverage of residence hall access doors
- Halls accessed by electronic proximity key fobs
- Room keys issued directly to each student

### Staff

- Resident assistants (RAs): under graduate who live on the student floors
- Coordinators for residence education (CREs), full-time administrative staff who live in the residence halls
- Administrative specialists, full-time staff at the front desks
- Facilities staff including institutional service assistants and maintenance personnel



UNIVERSITY OF  
ARKANSAS

Student Affairs  
University Housing

[movein.uark.edu](http://movein.uark.edu)

Call

#UARKHome