

# Maple Hill South

Maple Hill South Student Room



## Street Address:

645 N. Hall Avenue  
Fayetteville, AR 72701

## Mailing Address:

Your Name, (Your Box #)  
Maple Hill South  
645 N. Hall Ave.  
Fayetteville, AR 72701

## Front Desk

Front Desk: 479-718-7868

## Double Room Features

2 Twin loftable beds (Mattress:  
long twin - 36" x 75")  
2 Single desks (48" x 24" x 30")  
2 Desk chairs (23" x 21" x 33")  
2 Bookshelves/Hutches (48" x 10" x 23")  
2 Bulletin Boards under bookshelves  
2 Chests of drawers (16" x 18" 30")  
2 Wardrobes (35" x 24" x 81")  
Window with blinds (38 1/2" W x 62" H)

Bedrooms are approximately  
13'7" deep and 11'7" wide

This hall has different floorplans from the one  
above, please see the Maple Hill South web  
page for more information

Room/suite amenities include, but are not  
limited to:

- Ethernet and wireless internet access
- Cable TV
- Networked smoke detector
- Sitting room/foyer
- Vanity with sink and lighted mirror
- Shower and toilet

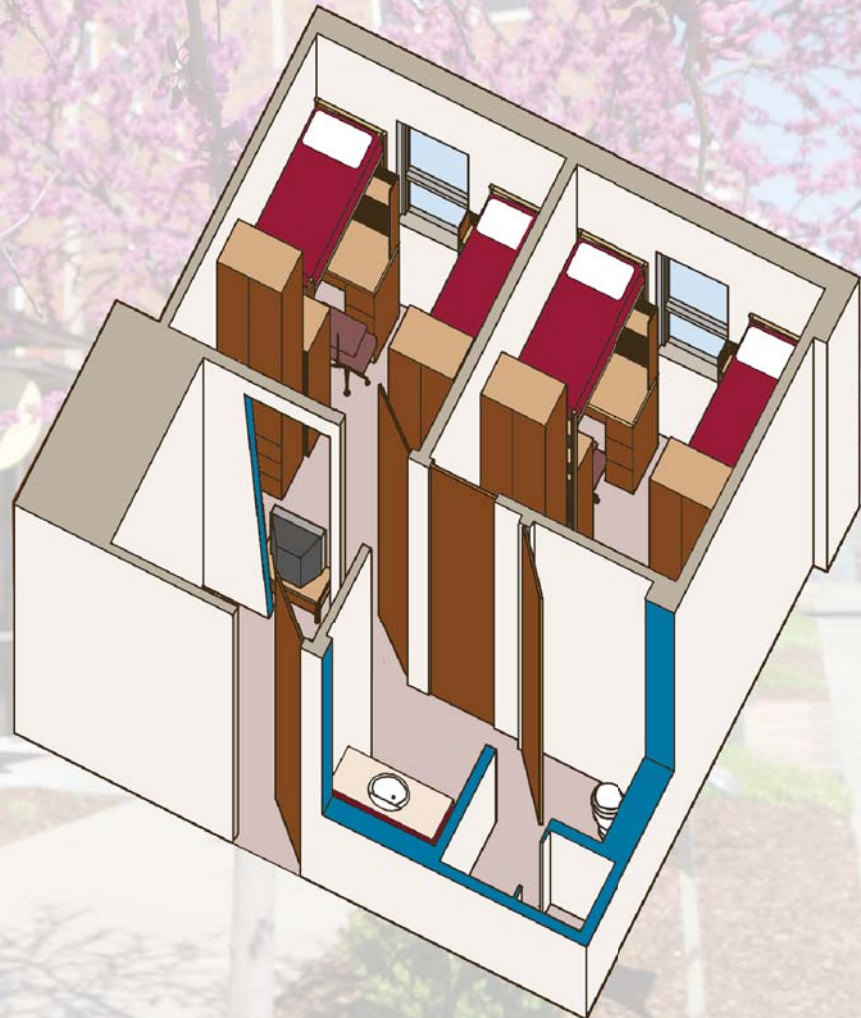

# Maple Hill South

Maple Hill South houses 356 students in semi-suite double rooms where four students share a bathroom. Each student floor includes a TV/kitchen room, quiet study rooms and group study rooms. Maple Hill South also features a first floor sitting room with fireplace.

Maple Hill South view from southwest



## FIX IT

<http://housing.uark.edu/fixit>  
479-575-7005

- Student room repairs
- Replace burnt-out lights
- Bathroom sanitation

## ResNet

<http://housing.uark.edu/ResNet>  
479-439-8070

- Assistance connecting devices
- Assistance with bandwidth issues
- Help with wireless connection



## Safety Features

### Security

- Exterior doors locked or supervised 24 hours a day
- Smoke/particle detectors
- Common-area sprinklers
- Closed circuit TV coverage of residence hall access doors
- Halls accessed by electronic proximity key fobs
- Room keys issued directly to each student

### Staff

- Resident assistants (RAs): under graduate who live on the student floors
- Coordinators for residence education (CREs), full-time administrative staff who live in the residence halls
- Administrative specialists, full-time staff at the front desks
- Facilities staff including institutional service assistants and maintenance personnel



UNIVERSITY OF  
ARKANSAS

Student Affairs  
University Housing

[movein.uark.edu](http://movein.uark.edu)

Call

#UARKHome