

Pomfret Hall



Pomfret Student Room



Street Address:

31 S. Stadium Drive
Fayetteville, AR 72701

Mailing Address:

Your Name
Pomfret Hall, (*Your Box #*)
31 S. Stadium Drive
Fayetteville, AR 72701

Front Desk: 479-718-2502

Double Room Features

- 2 Twin beds (Mattress: regular twin - 36" x 75")
- Double desk (84" x 24" x 31")
- 2 Desk chairs (23" x 21" x 33")
- Bookshelves over desk (84" x 9" x 31")
- 2 Closets (48" x 32" x 96")
- Double dresser (70" x 24" x 40")
- Lighted Mirror (60" W x 27" H)
- 2 Bulletin Boards (43" W x 32" H)
- Window with blinds (114" W x 57" H)
- Ledge (9'6" x 16" x 37")

Bedrooms are approximately 13'6" deep and 9'9" wide

This hall has other floor plans different from the one shown; please see the Pomfret Hall web page for more information.

Room amenities include, but are not limited to:

- Ethernet and wireless access
- Cable TV
- Networked smoke detector

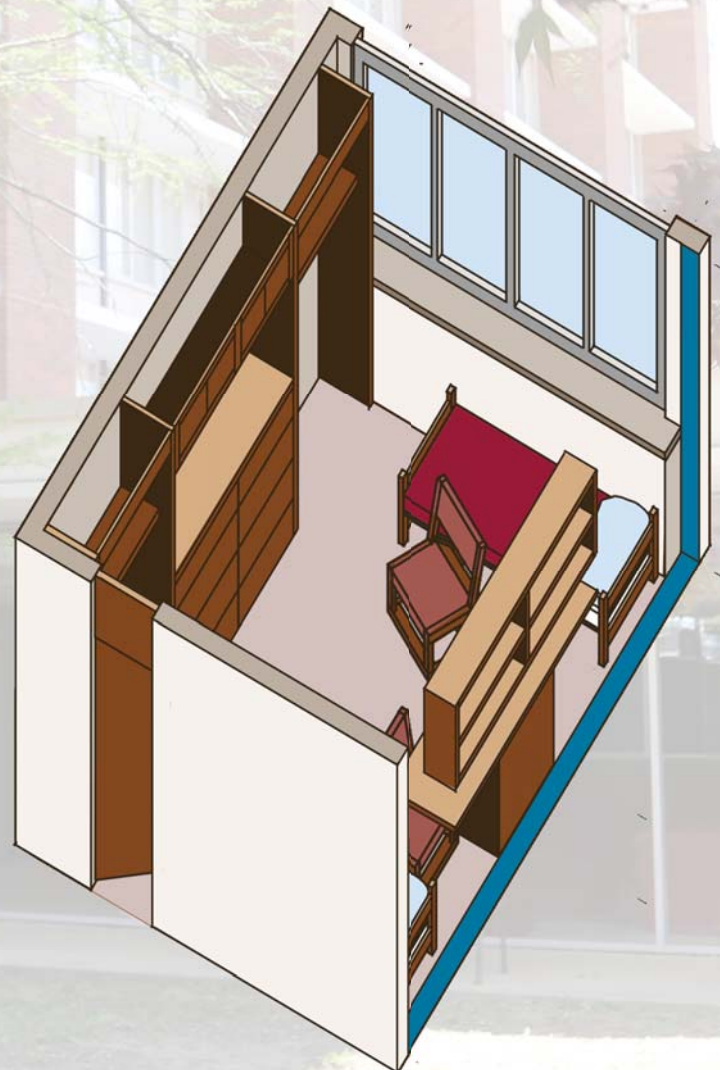

Pomfret Hall

Pomfret is the largest residential complex on the University of Arkansas campus, with 800 students in three residential wings. It includes a dining center and ground floor Great Room, a TV and music room and houses the Air Force ROTC, Diversity Scholars and Music Living Learning Communities. It is located on the south end of campus next to the Bud Walton Arena and the Jones Student Athlete Success Center.

Pomfret Hall Courtyard from the north



FIX IT

<http://housing.uark.edu/fixit>
479-575-7005

- Student room repairs
- Replace burnt-out lights
- Bathroom sanitation

ResNet

<http://housing.uark.edu/ResNet>
479-439-8070

- Assistance connecting devices
- Assistance with bandwidth issues
- Help with wireless connection



Safety Features

Security

- Exterior doors locked or supervised 24 hours a day
- Smoke/particle detectors
- Common-area sprinklers
- Closed circuit TV coverage of residence hall access doors
- Halls accessed by electronic proximity key fobs
- Room keys issued directly to each student

Staff

- Resident assistants (RAs): under graduate who live on the student floors
- Coordinators for residence education (CREs), full-time administrative staff who live in the residence halls
- Administrative specialists, full-time staff at the front desks
- Facilities staff including institutional service assistants and maintenance personnel



UNIVERSITY OF
ARKANSAS

Student Affairs
University Housing

movein.uark.edu

Call

#UARKHome